

**ROCKVILLE TECHNOLOGY BUSINESS INCUBATOR**

ROCKVILLE CULTURAL ARTS BUILDING  
ROCKVILLE TOWN SQUARE BLOCK 3A  
ROCKVILLE, MARYLAND

**OWNER**

CITY OF ROCKVILLE  
MAYOR AND COUNCIL  
111 MARYLAND AVENUE  
ROCKVILLE, MARYLAND 20850  
TEL: (410) 884-5350  
FAX: (410) 884-5394

**MANAGER**

FEDERAL REALTY INVESTMENT TRUST  
210 DEVELOPMENT MANAGEMENT GROUP  
2017 DURHAM ROAD EAST  
COLUMBIA, MARYLAND 21044  
TEL: (410) 884-5350  
FAX: (410) 884-5394

**ARCHITECTS**

D'AGOSTINO IZZO QUIRK ARCHITECTS  
1310 BROADWAY  
SOMERVILLE, MASSACHUSETTS 02144  
TEL: (617) 623-3000  
FAX: (617) 623-3688

**STRUCTURAL ENGINEER**

McNAMARA / SALVIA, INC.  
160 FEDERAL STREET, 5th FLOOR  
BOSTON, MASSACHUSETTS 02110  
TEL: (617) 737-0040  
FAX: (617) 737-0042

**MECHANICAL ENGINEER**

E & S MECHANICAL ENGINEERS  
4326 MOUNTAIN ROAD  
PASADENA, MARYLAND 21122  
TEL: (410) 360-2280  
FAX: (410) 360-2290

**ELECTRICAL ENGINEER**

B & R CONSTRUCTION SERVICES  
502 MCCORMICK DRIVE, SUITE M  
GLEN BURNE, MARYLAND 21061  
TEL: (410) 761-9600  
FAX: (410) 761-9603

**LIFE SAFETY**

KPT ENGINEERING CORP.  
35 OXFORD WAY  
HUNTINGTON, MARYLAND 20639  
TEL: (301) 855-5420  
FAX: (301) 855-5124



**REVISIONS:**

21 FEB 2007	SQFT CALCULATIONS

**KEY PLAN:**

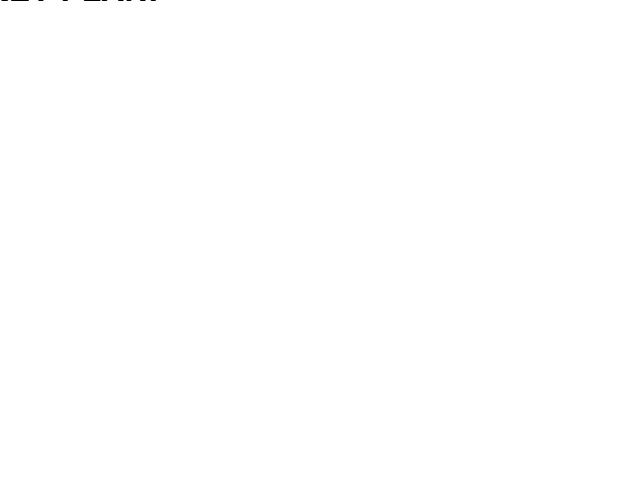

**DRAWING TITLE:**

**FIFTH LEVEL OFFICE PLAN SQ FOOTAGE CALC**

SCALE: 1/8" = 1'-0"	DRAWN BY: CMD
JOB NUMBER: 0501.03	DATE: DD MONTH 2006
	SHEET NUMBER:

**5FL**

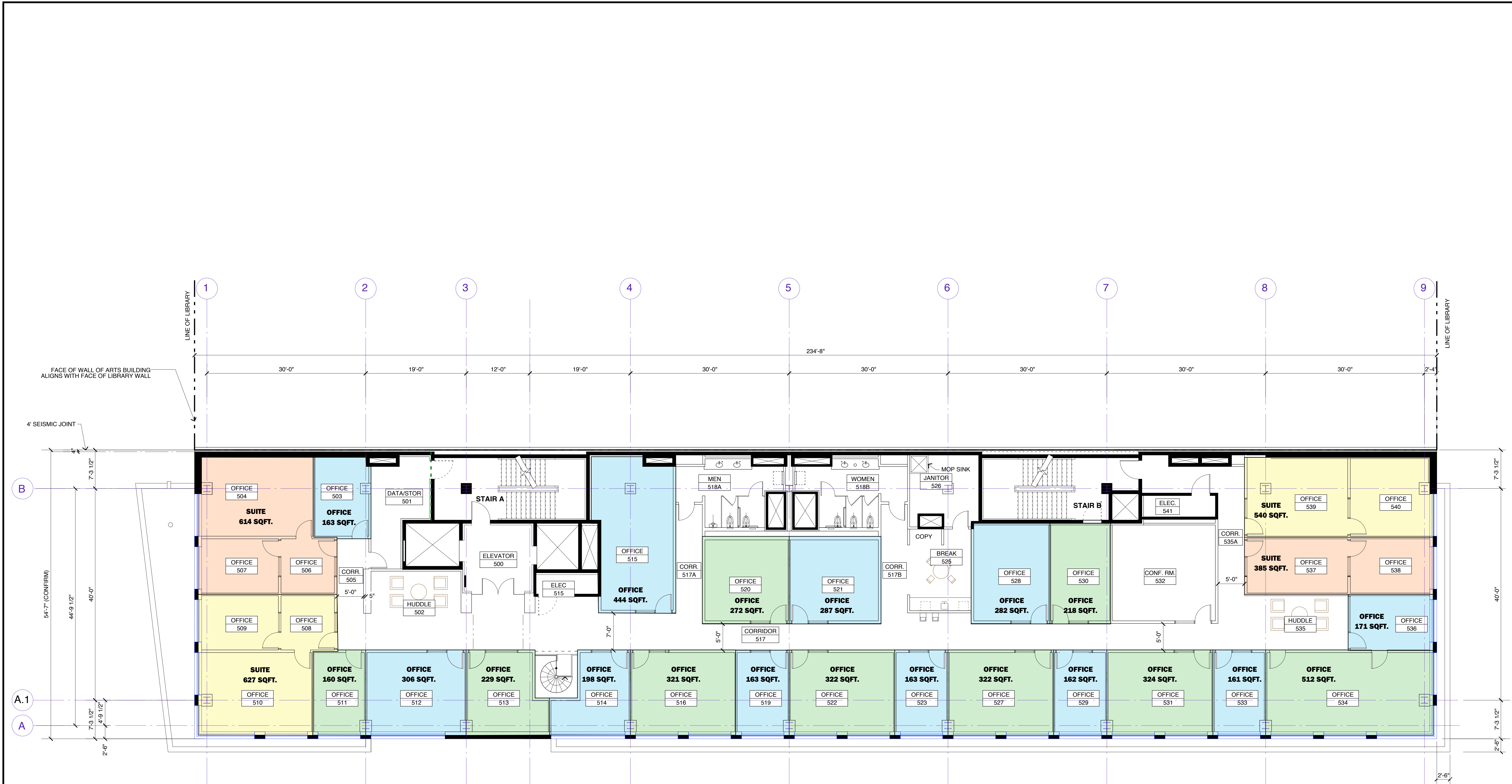

**LEASEABLE SPACE KEY**

<span style="display:inline-block; width:15px; height:15px; background-color:lightgreen;"></span>	<span style="display:inline-block; width:15px; height:15px; background-color:lightblue;"></span>	BLUE OR GREEN DENOTES DESIGNATED OFFICE SPACE.
<span style="display:inline-block; width:15px; height:15px; background-color:orange;"></span>	<span style="display:inline-block; width:15px; height:15px; background-color:yellow;"></span>	ORANGE OR YELLOW DENOTE DESIGNATED SUITES OF OFFICES

**FIFTH FLOOR TOTAL LEASABLE SQUARE FOOTAGE (LABELED "OFFICE" OR "SUITE"): 7,346 Sq ft**

